

NUDO®

YOUR VISION IS OUR MISSION™



ACM WALL PANEL SYSTEMS

NUDO WS-4475

NUDO DS-4485

NUDO RS-4495

WET-SEAL

DRY-SEAL

RAIN SCREEN



NUDO ACM WALL PANEL SYSTEMS

Nudo Products offers ACM wall panels in 3 different systems covering the large majority of ACM projects specified. ACM systems are compatible with all major ACM manufacturers, including Nudo's own EnduroBond ACM. Basic install details and product info are available for all systems upon request. With over 60 years experience and thousands of projects completed, Nudo Products has the ACM system to meet your needs.



** Nudo EnduroBond flat sheet available for customer fabrication upon request.

NUDO WS-4475 WET-SEAL

Nudo's WS-4475 wet-seal ACM system is a caulked ACM system. This system has a typical overall depth of 1" and a typical caulk joint width of 1/2". Both the system depth and caulk joint width can be varied upon request. This system consists of pre-routed ACM panels which will be folded into pans and attached to the façade, in the field, with supplied angle clips. This has proven to be a very successful system on a wide range of wet-seal ACM applications.

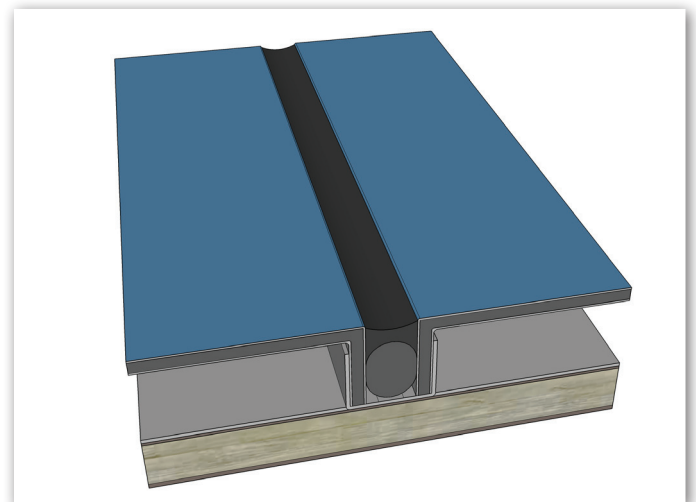

NUDO DS-4485 DRY-SEAL

Nudo's DS-4485 dry-seal ACM system is our answer to cost concerns that can arise with some extruded aluminum rain-screen systems. While we do offer a true extruded aluminum system as well (4495), our 4485 system has proven to be a strong value engineering option for anyone looking to achieve the much sought after "reveal" look.

This system installs very similarly to our caulked system with simple ACM panels pre-routed and installed with angle clips. In addition, there is a Nudo supplied wall plate installed at all joints prior to panel installation.

After panels are installed, rather than caulking, high-bond tape & silicone sealant are applied to the joint along with a color matched filler strip (see picture). This system has a typical overall depth of 1 5/8" and standard joint width of 3/4".

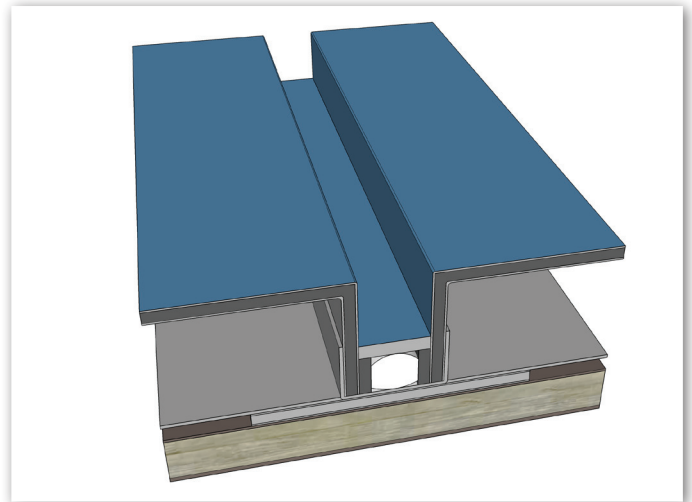

NUDO RS-4495 RAIN SCREEN

Our Nudo RS-4495 rain screen ACM system is our top of the line panel system. This drained and back-ventilated system incorporates full SAF extruded aluminum internal framework attached with counter-sunk rivets for a clean look. SAF extruded aluminum wall clips and tracks and a color matched ACM filler strip tie the system together for a truly impressive final product.

This system has an overall depth 1 7/8" with 1/2" wide 'reveal' joints (no caulking). RS-4495 is designed to take on water but allow the water to move behind the system and either evaporate or exit via weep holes in the system itself.

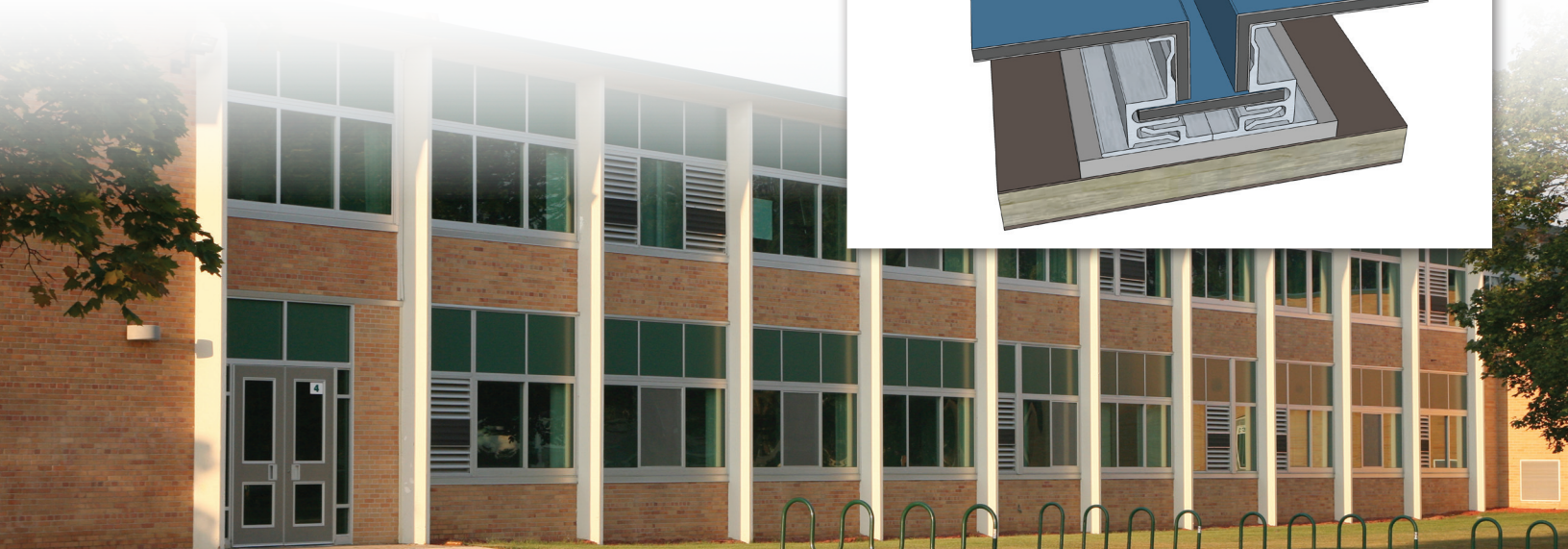
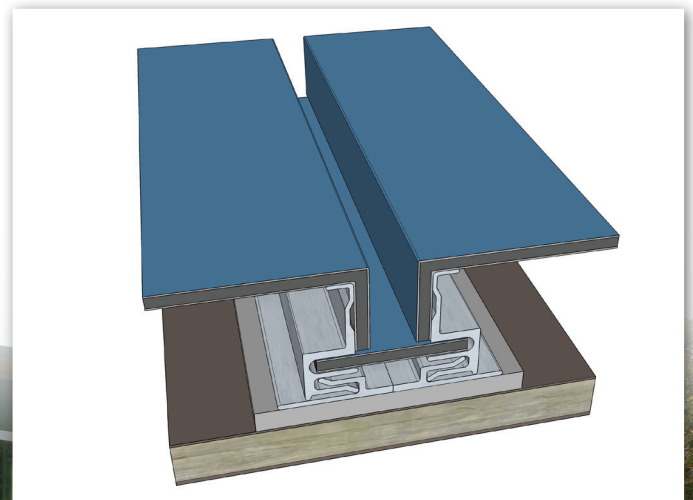

IT'S ABOUT YOU

At Nudo, it's more about you than us. We are customer-focused and that means you can expect the responsiveness, consistency and solutions you need.

Responsiveness

- With over 60 years of experience, we understand the demands and expectations of the building, architecture, transportation and sign industries.
- Our goal is to make things easy for you, and that means a simple ordering process, fast turn times and our own transportation network that allows us to provide industry leading, on-time delivery on a dedicated truck.
- Our customer satisfaction score is the highest in our industry and a true testament to our understanding that you need answers quickly.



Consistency

- With an on-time delivery rate of 99% and a return rate of less than 0.2%, we stand behind our products and stand firm on 100% customer satisfaction - period!
- We are rated as having the best service in the industry by an independent assessment.
- We know trust is earned and can never be taken for granted. From the first order and every subsequent one after that, you can depend on us to deliver the right product at the right price at the right time.

Solutions

- We know that one size doesn't fit all. We address the variables that are inevitably present in any project and use our knowledge to provide you with product options that best suit your needs.
- Couple our wide variety of inner layer options, surface materials, substrates, thicknesses, sizes and colors with our specialized manufacturing equipment and extensive stocking level of raw materials and we can provide custom solutions for just about any panel need.

NUDO®

1500 Taylor Avenue
Springfield, IL 62703
www.Nudo.com

Ph: 800.826.4132
Fax: 217.528.8722

Rev 11/14

Visit www.Nudo.com or
contact our local dealer for details.